

# LEGEND

- ROAD CENTRELINE
- KERB TOP
- KERB BOTTOM
- FOOTPATH
- RETAINING WALL
- PAD EXTENT
- E ELECTRIC CABLE U/G
- T TELECOM CABLE U/G
- W WATER PIPE U/G
- S SEWER PIPE U/G
- D DRAINAGE PIPE U/G
- SUBSOIL PIPE U/G
- BOUNDARY LINE
- WATER METER
- + PAD LEVEL
- DRAINAGE MANHOLE / STRUCTURE
- SEWER MANHOLE
- ELECTRIC LIGHT POLE
- ELECTRIC DOME
- TELECOM PIT OR BOX
- WATER VALVE
- WATER HYDRANT
- SUBSOIL STRUCTURE

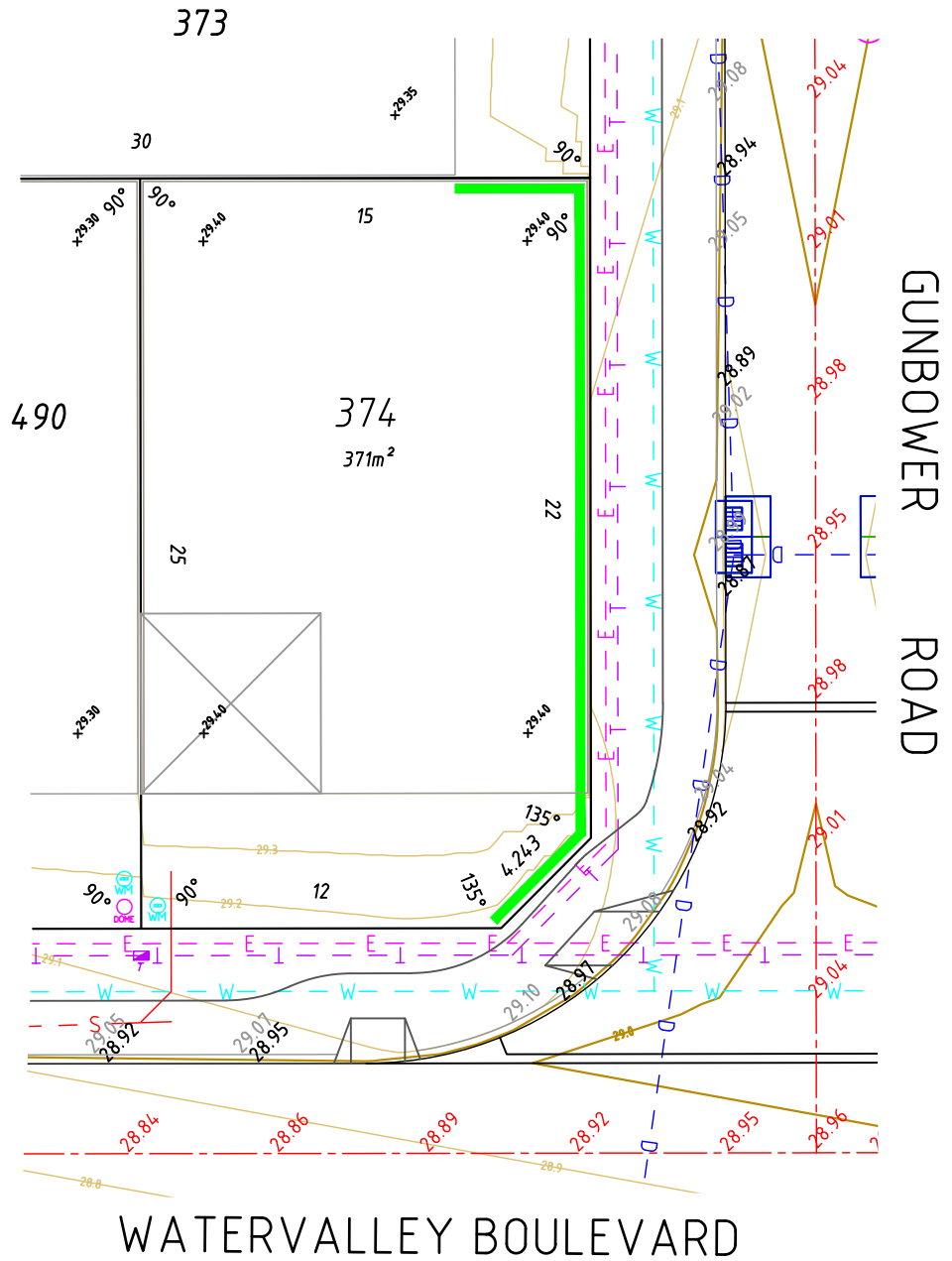

### NOTES

The service and engineering information shown is from design drawings and should not be construed as being the "As-Constructed" details.

It is acknowledged that the dimensions and areas, as well as the location of services and the existence and width of easements are subject to change in accordance with the requirements of any relative Authority. The particulars of this plan are supplied for information only representing the facts at the time of printing and may change. The particulars shall not be taken as a representation in any respect on the Vendor or its Agent. Authorities should be consulted in relation to any limitations or requirements as building restrictions may apply.

SCALE 1:250



ALL DISTANCES ARE IN METRES

Survey Date: N/A	Surveyed By: N/A	
Drawn Date: 08/08/2018	Drawn By: ANC	
Scale (A4): 1:250	Approved By: STP	
Hor Datum: PCG94	Vert Datum: AHD	

WESTERN AUSTRALIA  
T 08 6241 3333  
veris.wa@veris.com.au  
www.veris.com.au

veris

DEVELOP WITH CONFIDENCE™

DESIGN SITE PLAN

LOT 374 WATERVALLEY BOULEVARD  
ARIELLA PRIVATE ESTATE  
BRABHAM

• This plan must not be reproduced without the permission of VERIS

Data File: VARIOUS
CAD File: PRESTON 180803_Ariella_Estate_St6_DSP_Master.dwg
Path: S:\Projects\16\16561\survey\design site plans\Stage 6

Client: CEDAR WOODS

Job No	Item No	Plan No	Rev
16561	- 000	- 355	- 00
Sheet 1 of 1			

